



ALEX

Stand-Alone Board-In Crimp Terminals

97T Series

P.C. Board Crimp Terminal

- Secure wire to P.C. Board before wave soldering
- Rapid and economical means of hand wiring P.C. Board
- Wire solders directly to P.C. Board
- No additional contact resistance
- Low profile
- Recommended P.C. Board hole diameter ϕ 1.8+0.1/-0 mm
- Applicable P.C. Board thickness 1.6mm
- Accepts wire size #18 ~ #24 AWG
- A maximum protrusion below the P.C. Board of 2.7mm
- Material: Pre-tinned Brass or Phos. Bronze available
- Q'ty: 5000 PCS/Reel

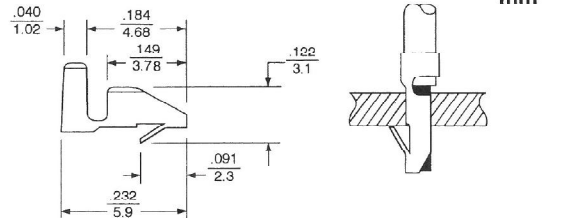

Part No	Material
97T-1252	Brass
97T-1552	Phosphor bronze

98T Series

P.C. Board Multi-Crimp Terminal

- Secure wire to P.C. Board before wave soldering
- Rapid and economical means of hand wiring P.C. Board
- Wire solders directly to P.C. Board
- No additional contact resistance
- Low profile
- Recommended P.C. Board hole diameter ϕ 2.3+0.1/-0 mm
- Applicable P.C. Board thickness 1.6mm
- Accepts wire size #16 ~ #20 AWG or #18 AWG x2 max.

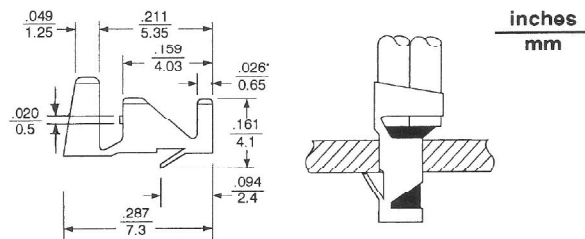

- A maximum protrusion below the P.C. Board of 2.7mm
- Material: Pre-tinned Brass or Phos. Bronze available
- Q'ty: 3500 PCS/Reel

99T Series

P.C. Board Multi-Crimp Terminal

- Secure wire to P.C. Board before wave soldering
- Rapid and economical means of hand wiring P.C. Board
- Wire solders directly to P.C. Board
- No additional contact resistance
- Low profile
- Recommended P.C. Board hole diameter ϕ 3.2+0.1/-0 mm

- Applicable P.C. Board thickness 1.6mm
- Accepts wire size #12 ~ #14 AWG or bundle wire range: #18 AWG x4 max.
- A maximum protrusion below the P.C. Board of 2.2mm
- Material: Pre-tinned 0.3mm brass
- Q'ty: 1800 PCS/Reel

